

# BALPI - BALPI LIGHT

Ref. 1426 - 1483

Ship.	Code	Designation
J+5	1090711	10 X NYLON WASHER
J+5	1090759	2 X 10 PLASTIC FILTER FOR B8/B10/B15/B19
J+5	1090775	10 X FREE RUBBER
J+5	1090777	5 X COMPLETE PRESSURE ADJUSTMENT
J+5	1090778	10 X FLAT JOINT
J+5	1090779	10 X STAINLESSSTEEL NUT 1/2
J+1	1090780	10 X STAINLESSSTEEL SPRING
J+1	1090797	BAG 10 RUBBERS B8/B10/B15S/BALPI/BALP
J+5	1090819	SET OF 10 O-RINGS B10
J+5	1090876	VALVE UNDERPART BALP BLISTER PACK
J+5	1091046	BAG WITH 10 JOINTS/BALPI-LOW PRESSURE
J+5	1290114	LOCKING WEDGE IN PLASTIC/BALPI
J+5	2260903	SCREW + SEAL
J+5	4050853	SS.BODY
J+5	4050854	CONNECTING BODY
J+5	4050873	CPLTE VALVE BALPI
J+5	4082110	ACTIVATOR PIN B8/B10/B15S/BALPI/BALP
J+5	4130165	ENAMELLED BOWL BALPI
J+5	4130167	BALPI LIGHT BOWL (SYNTHETIC)

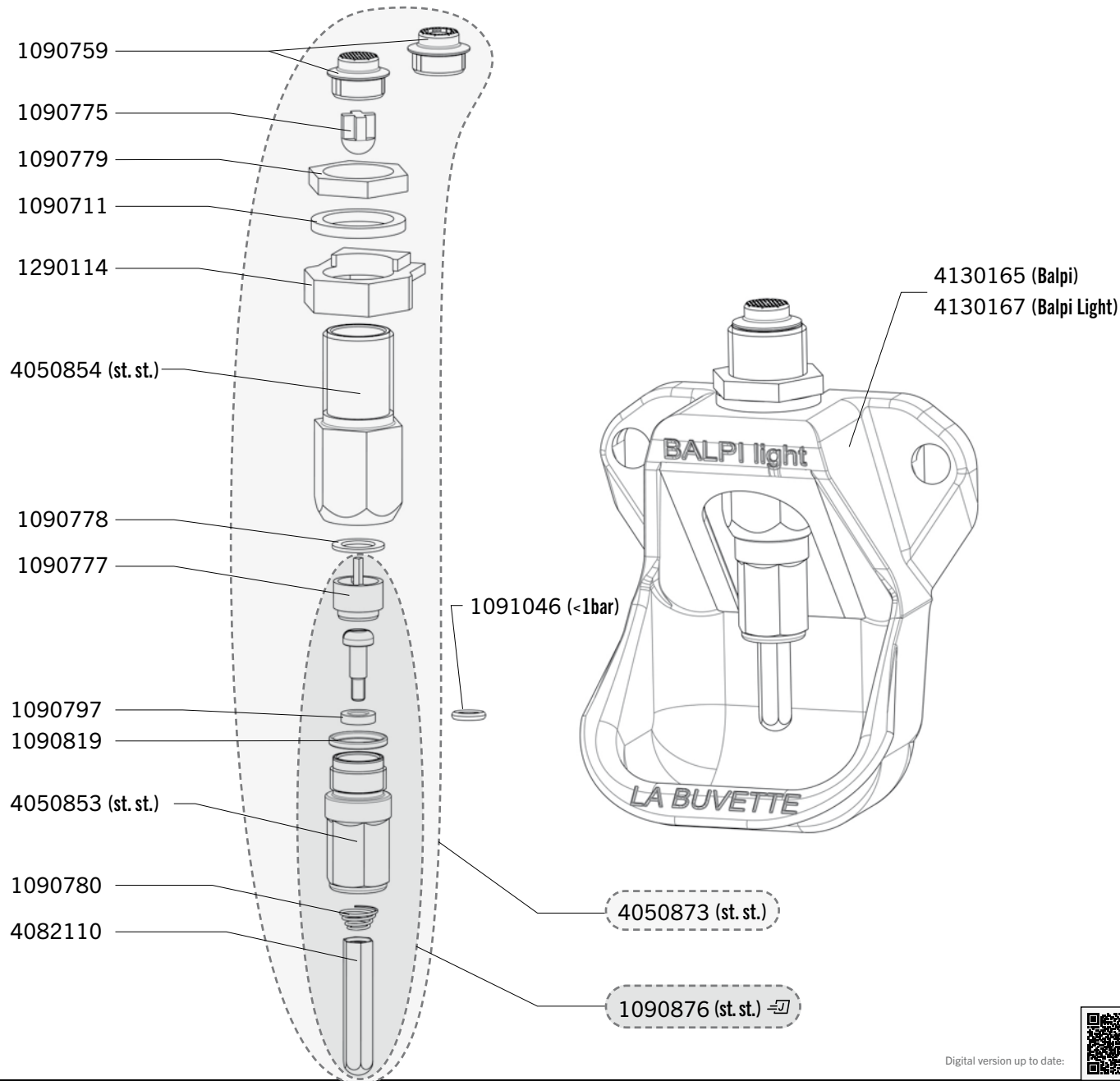

Shipping time in working days (running out of stock excepted), spare parts tagged with a (J) are dispatched the same day if order received before noon and made of parts tagged with (J) exclusively.

Digital version up to date:

